

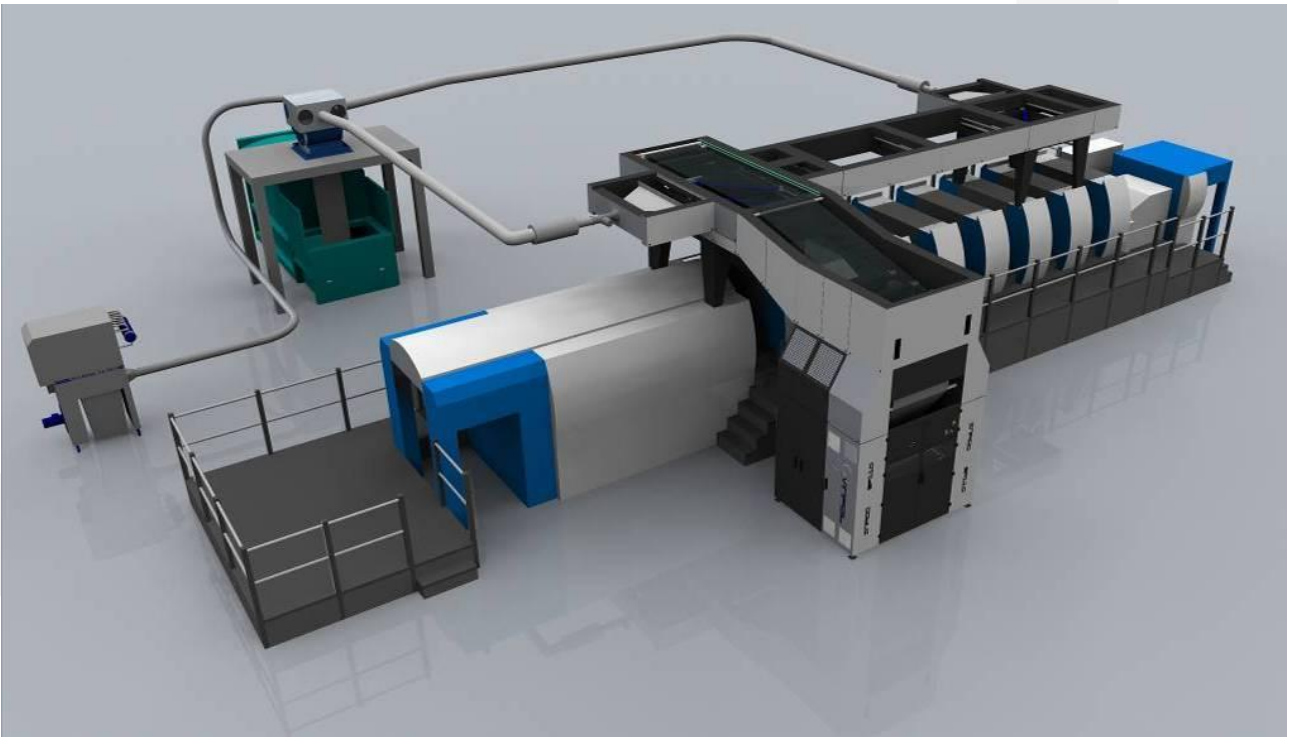

SCAPER EUROPE GMBH

Vinfoil Infigo SF110 UFC module for UV Film Casting application







What is UV Film Casting (UFC)

The Cast and Cure process uses a holographic film in combination with a UV coating on any substrate to “cast” a holographic effect into the UV coating. While the holographic film, UV coating and substrate are in contact, the UV coating is “cured.” Then, as the film is removed from the substrate, the holographic effect is left on the surface of the material in the UV coating. Since there is no transfer of material taking place, as in cold foil, the film is re/usable.

Highlights all Infigo SF110 Models

- § Because of the unique DFD (Direct Foil Drive) unit, a speed of up to 18.000 sheets/hour is achievable with the best cold foil printing result. (depending on printing press, paper/carton, foil, UV varnish and blankets)
- § Changing the foil reel takes place at ground level with an electrical roll manipulator – making a very easy and safe operation
- § The cast & cure film will be unwind and wind at the same time
- § The cast & cure film can be re-used many times, due to the perfect re-winding process
- § Film reel changing on ground level in less than 5 minutes
- § Automatic film roll change with motorized foil pull-in systems. Production is interrupted for only maximum 5 minutes

The principle of Vinfoil in the UFC mode

- § The cast & cure film will be unwind and wind at the same time
- § The cast & cure film can be used many times, due to the perfect rewinding process
- § Because of the unique DFD (Direct Foil Drive) unit, a speed of up to 18.000 sheets/hour is achievable with the best film result. (depending on printing press, paper/carton, film, adhesive and blankets)
- § Film reel changing, with assistance of an electrical roll manipulator on ground level, takes place in less than 5 minutes

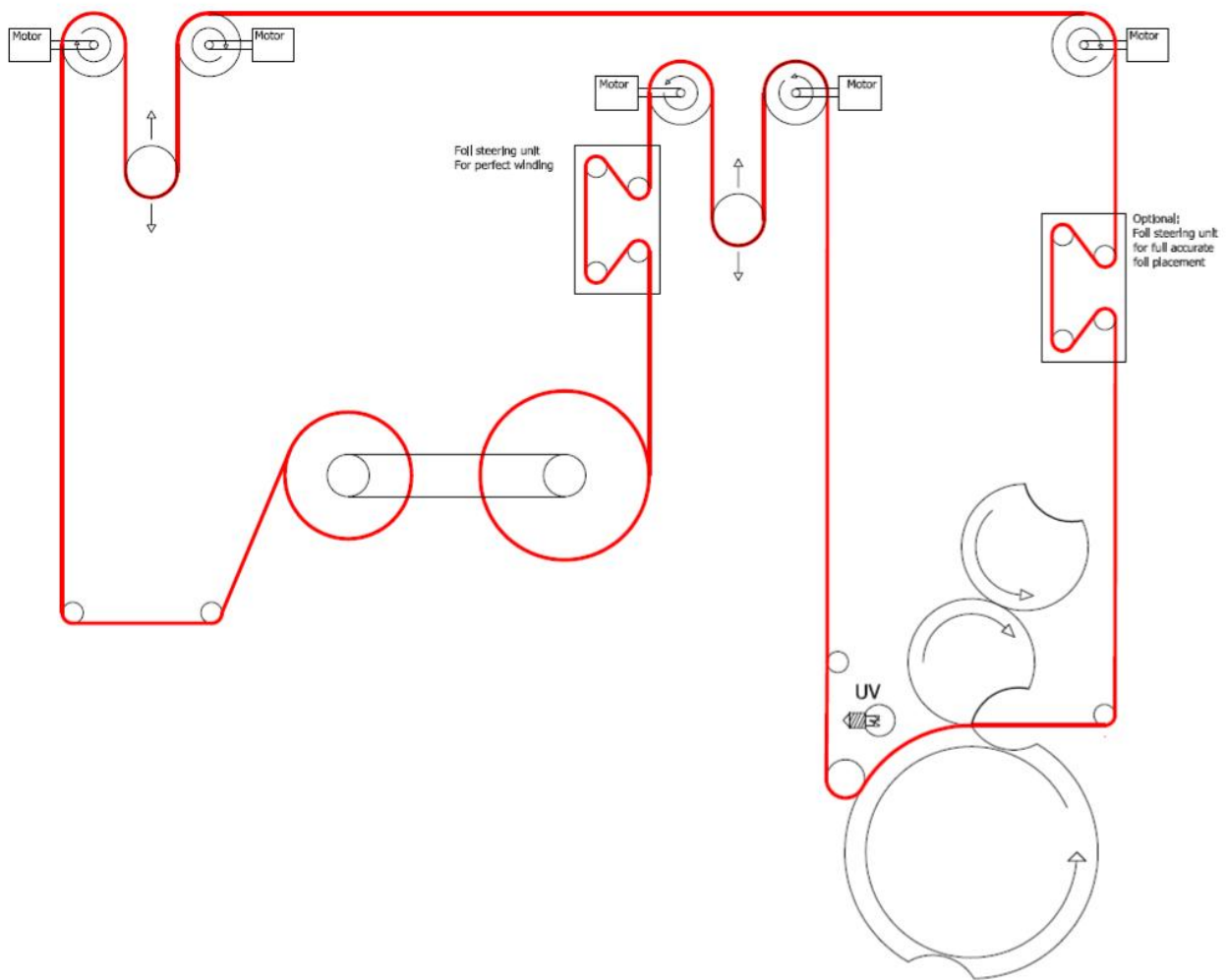

Description of all individual Infigo sections in UV Foil Casting mode

Film Loading Station (FLS)

- § Splicer with vacuum bar to prepare the new film for the glue cycles
- § Film storage – under pressure controlled – for leveling out the unbalance in the film supply during the production with high speed and to guarantee a perfect web tension
- § Extra film storage – under pressure controlled – so that the rewinding process is optimal without distorting of the expensive holographic film
- § Web guide for perfect rewinding
- § Vacuum rollers, driven by Bosch Rexroth servo motors. The very sensitive hologram layer of the film never comes into contact with any part of the Infigo unit
- § Electrical roll manipulator for easy loading and unloading the film reels

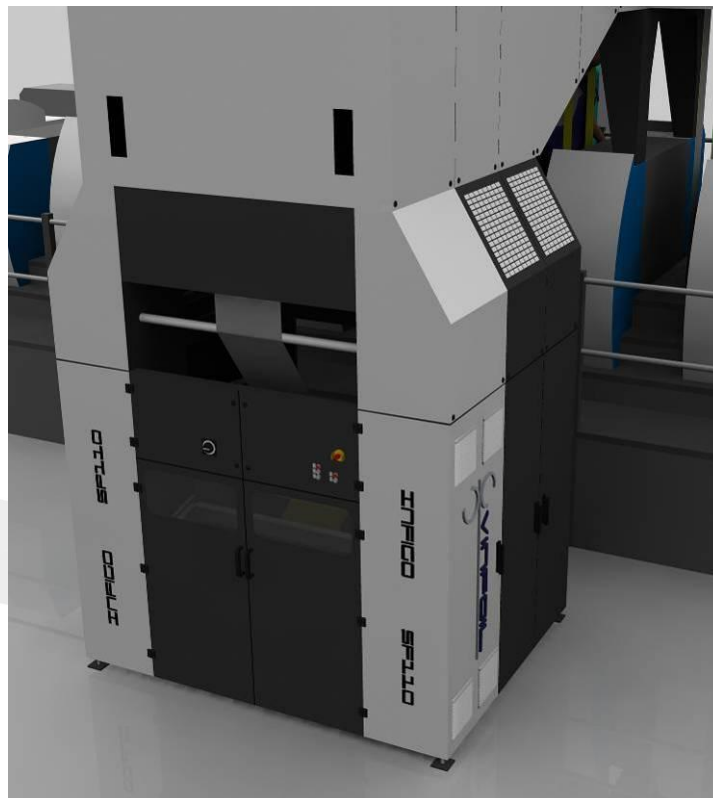

Cross Section (CS) in UV Film Casting mode

- § This module will be only working with 1 turning bar
- § Motorized film pull-in systems from film loading station to the cross section

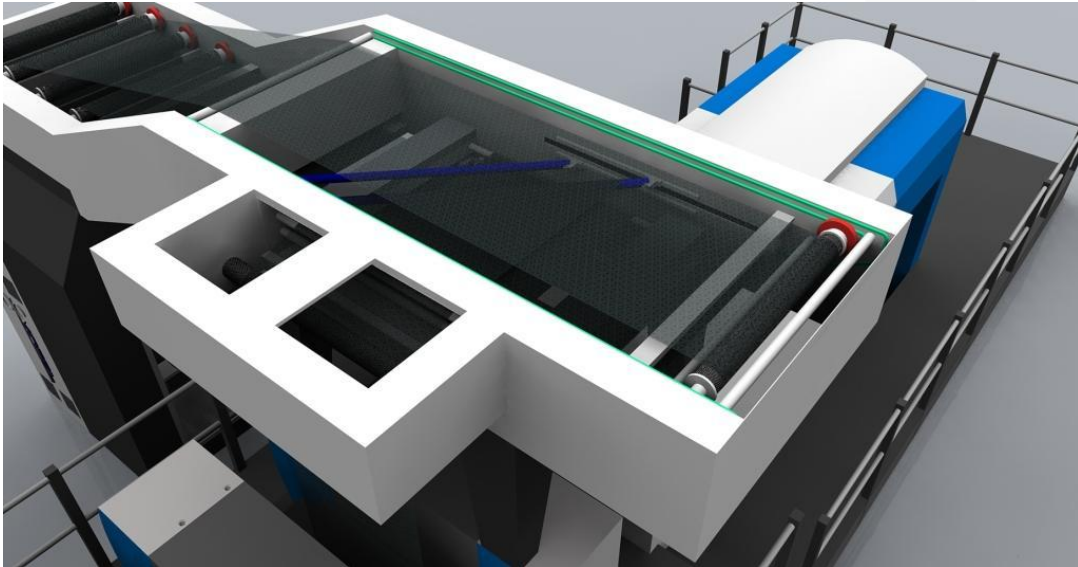

Direct Foil Drive (DFD) in UF Film Casting mode

- § The film web speed is controlled by 2 Bosch Rexroth servo motors – these motors are controlled by an encoder mounted on the printing press, thus guaranteeing a very precise synchronization of the film web with the speed of the printing press
- § Electronically adjustable web tension

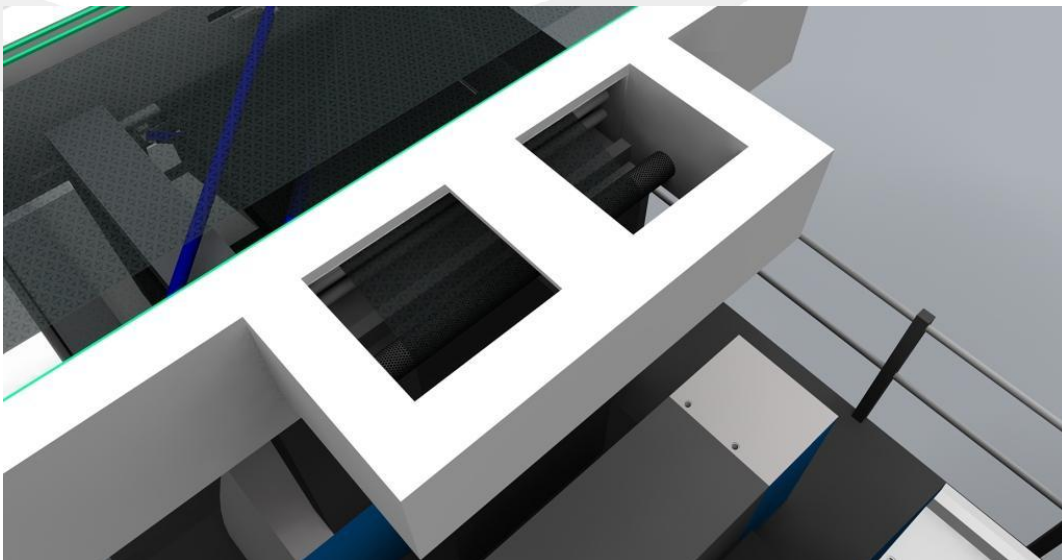



Film Return section (FR)

- § This module is mounted between the support frame on top of the printing machine and the cross section, to ensure the Holographic Film web returns back to the external splicer.
- § This module will be delivered with 1 turning bar
- § Also here the very sensitive hologram film never comes into contact with any part of the Infigo unit.

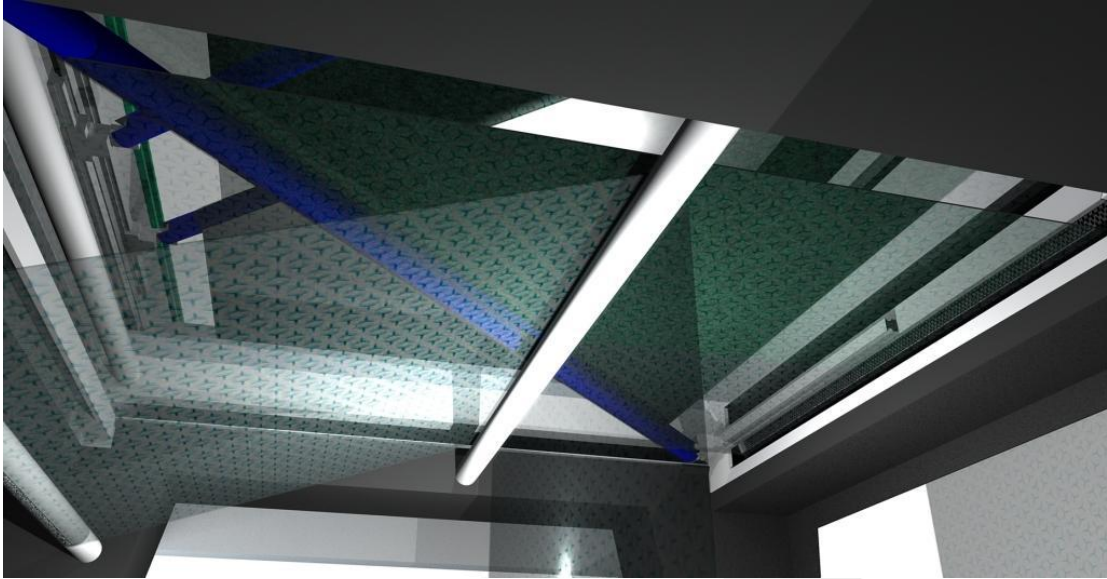

Specifications

Power / air

§ Power voltage	400 V / 50 Hz
§ Total power supply	ca. 30 kW
§ Air supply	6 bar

General specifications

§ Total length (foil loading side)	2400 mm
§ Total width	1850 mm
§ Total height (depending on type machine and elevation height)	3600-3900 mm
§ Total net weight	7 t

Specifications Direct Foil Drive

§ Maximum foil/film roll diameter	450 mm
§ Foil core diameter	6"
§ Maximum foil/film width	1100 mm
§ Minimum foil/film width	150 mm
§ Minimum foil/film width after the cutting device (optional)	100 mm
§ Max. speed (depending on printing press, paper/carton, foil, adhesive and blankets)	18.000 sheets/hour

Specifications filter system

§ Filter system (L x W x H)	1655 x 800 x 2155 mm
§ Total net weight filter system	1500 kg

The machine is delivered with the European safety certificate CE.

SPECIFICATIONS ARE SUBJECT TO CHANGE WITHOUT NOTICE

